

PARKING COUNT:

TOTAL BUILDING AREA = 23,530 SF

PROPOSED RESTAURANT

RAISING CANE 3,530 SF

JAPANESE RESTAURANT 5,950 SF

CABO RESTAURANT 4,000 SF

COFFEE SHOP 1,500 SF

OTHER RESTAURANT 4,740 SF

RESTAURANT 19,720 SF X 8/1000 = 158

RETAIL 3,810 SF X 4/1000 = 15

TOTAL PARKING REQ'D: 173

TOTAL PARKING PROPOSE: 174

SUITE A	ITS A GRIND COFFEE SHOP	1,500 SF
SUITE B	CABO RESTAURANT	4,000 SF
SUITE C	AVAILABLE	6,500 SF
SUITE D	TX. CHEESE STEAK RESTAURANT	1,500 SF
SUITE E	BLUE FIN RESTAURANT	6,500 SF
TOTAL		20,000 SF

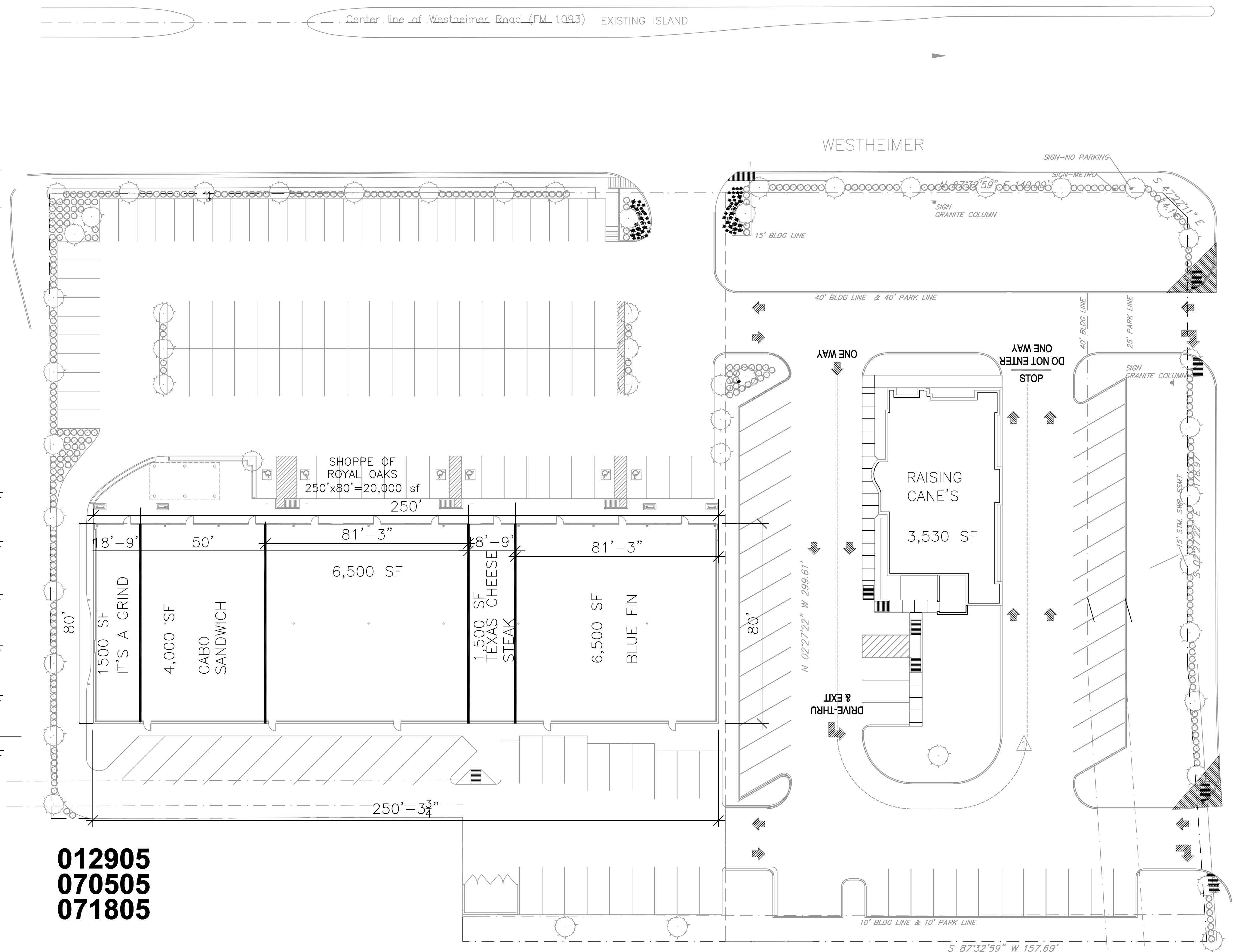

012905
070505
071805

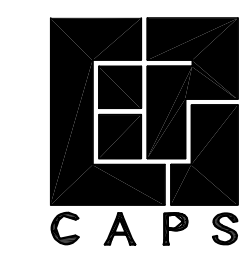

CAPS Consolidated Architecture and Planning Service Inc.

5700 Braxton, Suite 190 Houston, Texas 77036
(TEL) 713 783-9888 (FAX) 713 977-1311
Mail@capsarchitects.com

PROPRIETARY INFORMATION
DESIGN INFORMATION CONTAINED HEREIN IS THE EXCLUSIVE PROPERTY OF CAPS INC. AND HIS ENGINEERS. NO PORTION OF ANY DESIGN INFORMATION CONTAINED HEREIN MAY BE USED BY OR DISCLOSED TO, UNAUTHORIZED PERSONNEL WITHOUT EXPRESSED WRITTEN CONSENT.

ROYAL OAKS SHOPPING CENTER
12225 Westheimer Road
HOUSTO TX. 77077

DATE: 01/29/2005	ISSUE/REVISION:	DRAWN BY:	DRAWING TITLE: LEASE PLAN
		DATE: 03/23/2004	SHEET NO:
		PROJECT NO: 3080	
		CADD FILE:	